

1011 Warrenville Road

Suite 150

1011 Warrenville Road, Lisle, IL 60532

[Click for Virtual Tour](#)

HAMILTON PARTNERS  
www.hamiltonpartners.com



### SUITE FEATURES

- [Click here for Virtual Tour of 150Â](#)
- Beautiful first floor space available immediately
- Second floor pond/atrium views
- 6 private offices
- Kitchen
- Workroom

### FIRST FLOOR PLAN

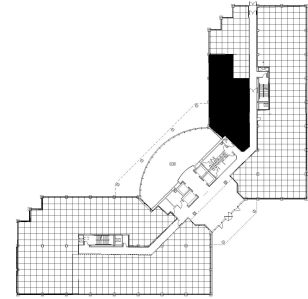

### DETAILS

**Square Feet:** 1,814 S.F.  
**Net Rent:** \$15.75/S.F.  
**OP. Expense:** \$9.01/S.F.  
**Tax:** \$2.61/S.F.  
**Gross Rent:** \$28.08/S.F.

### SPACE PLAN

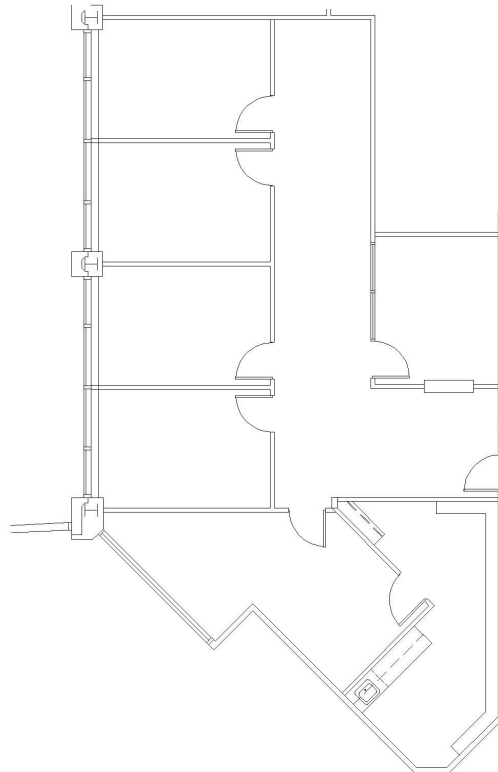

HAMILTON PARTNERS - Sponsoring Broker

**David Andrews**

[da@hpre.com](mailto:da@hpre.com)

C 6303270566

**Philip Sheridan**

[phil\\_sheridan@hpre.com](mailto:phil_sheridan@hpre.com)

P 6307195567

C 6303032108